

ThermaClad R-5 Exterior Panel

INSTRUCTION SHEET

OPTION 1: OSB ADJACENT TO FRAMING

ELEVATION

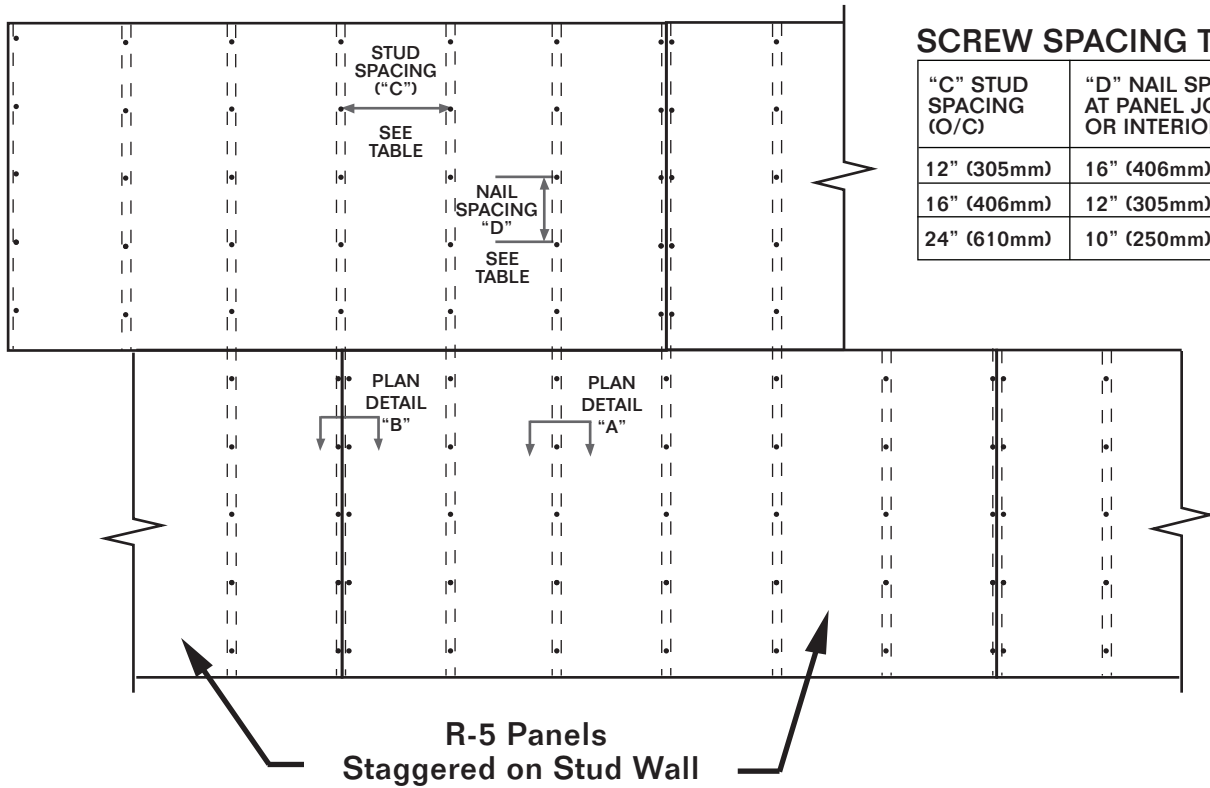

SCREW SPACING TABLE

"C" STUD SPACING (O/C)	"D" NAIL SPACING AT PANEL JOINTS OR INTERIOR
12" (305mm)	16" (406mm)
16" (406mm)	12" (305mm)
24" (610mm)	10" (250mm)

PLAN DETAIL "A" (AT PANEL INTERIOR)

PLAN DETAIL "B" (AT PANEL JOINTS)

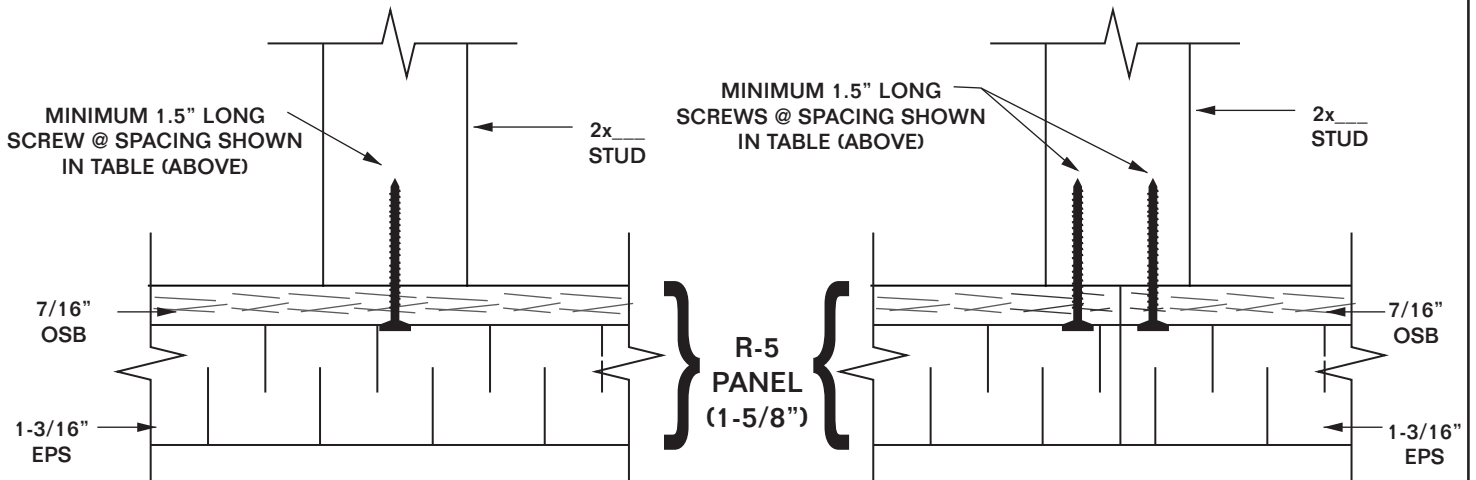

- NOTES: A. 7/16" OSB COMPLIES WITH CSA O325
 B. 1-3/16" EPS INSULATION COMPLIES WITH CAN/ULC- S701.
 C. SCREWS TO BE MINIMUM #6 FLAT HEAD WOOD SCREWS.
 D. IF WALL REQUIRED AS SHEARWALL, THEN CONFORM TO CODE REQUIREMENTS.
 #6 SCREWS ARE EQUAL TO 2.5" COMMON NAILS FOR SHEAR RESISTANCE.

ThermaClad R-5 Exterior Panel

INSTRUCTION SHEET

OPTION 2: EPS ADJACENT TO FRAMING

ELEVATION

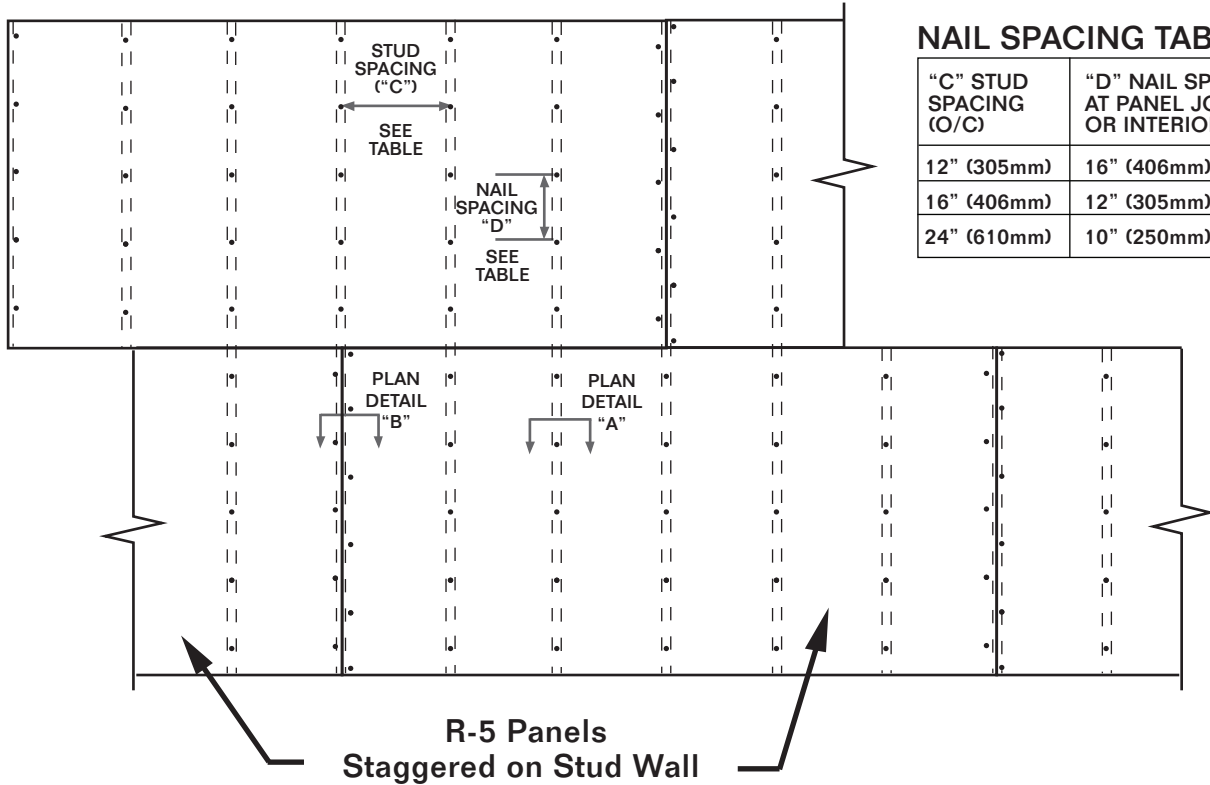

NAIL SPACING TABLE

"C" STUD SPACING (O/C)	"D" NAIL SPACING AT PANEL JOINTS OR INTERIOR
12" (305mm)	16" (406mm)
16" (406mm)	12" (305mm)
24" (610mm)	10" (250mm)

PLAN DETAIL "A" (AT PANEL INTERIOR)

PLAN DETAIL "B" (AT PANEL JOINTS)

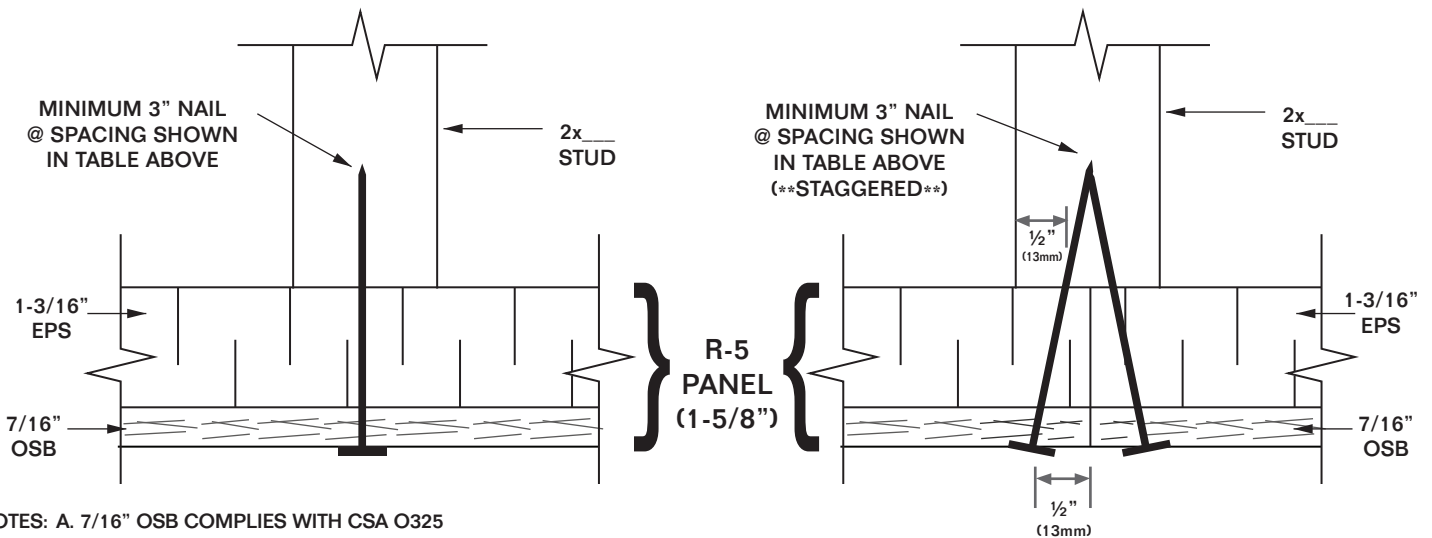

- NOTES: A. 7/16" OSB COMPLIES WITH CSA O325
 B. 1-3/16" EPS INSULATION COMPLIES WITH CAN/ULC- S701.
 C. NAILS TO BE 3" (75mm) LONG SPIRAL OR GUN NAILS; COMPLY WITH CSA B111.
 D. WALL BRACING TO CONFORM TO OBC 9.23.10.2: 1'X4' (19MM X 89mm) DIAGONAL BRACE OR INTERIOR FINISH CONFORMING TO SECTION 9.29.
 E. IF WALL REQUIRED AS SHEARWALL, THEN CONFORM TO CODE REQUIREMENTS.